

USER INSTRUCTIONS

Carabiner, model no. H619

Manufacturer or authorized representative:

**SEA SUN PROTECTIVE EQUIPMENT CO.,LTD.
39, XIAO KANG RD.,DONG CHEN,
RUGAO 226500,JIANGSU PROV.,CHINA.
TEL: +86(0)513 87618751**

Certification body: **Apave Exploitation France SAS (n° 0082)
6 Rue du Général Audran
92412 COURBEVOIE cedex - France**

Notified Body in charge of manufactured PPE control : **Module B &
Module D**

Notified Body name and address :

**Apave Exploitation France SAS (n° 0082)
6 Rue du Général Audran
92412 COURBEVOIE cedex - France**

Notified Body number : **0082**

These products are **A** classed as Personal Protective Equipment (PPE) by the European PPE regulation 2016/425 and through the **Harmonized European Standard EN362:2004**. These connectors which close automatically, design to be linked directly to a specific type of anchor as a component.

The EU declaration of conformity is available at www.seasunSAFE.com.

**ATTENTION: CAREFULLY READ THESE INSTRUCTIONS
BEFORE USING**

These instructions contain all the necessary information for correct and safe use of the connectors. The connectors covered in these instructions are personal protection devices designed to be integrated in fall arrest of personal protection systems, such as harnesses and cables. The full body harness is the only acceptable body holding device that can be used in a fall arrest system. The connectors are vital transmission component of the mechanical resistance between a proper anchorage point and the user who should accidentally fall. A malfunction due to improper use of the equipment is dangerous for the physical well being of the user. Verify that this product is compatible with the other elements of the system in your application (compatible=good functional interaction). Equipment used with your connector must meet current standards (e.g. EN354:2010 lanyard to work).

The connectors must be used as follows:

Closed – with the closing system;

Locked-without any constrictions or other pressures on the outer side of the connector, and avoid loading a connector across its gate.

Before using the connectors, the user must be adequately trained in the techniques and security measures to be adopted; those persons who are not trained or are not able to evaluate the dangers of the situations in which the devices are used must not use these devices. The users must be informed of the existence of an emergency plan, present at the place of work, necessary to handle any possible emergency that can arise.

If necessary, it will be prescribed to indicate that the product be delivered individually to the user; or else to have the product checked by competent persons before and after use. If necessary, there must be an adequately studied efficient and safe rescue method to be used should a person find himself in a difficulty while using this product. Always verify that the physical conditions of the user are such that the connector is used safely. Incorrect uses are many. Only some of these incorrect uses are included in these instructions and these are indicated with a cross over the illustrations

Always verify before use that your equipment consists of products compatible with each other and in conformity with the applicable regulations, standards and directives in force.

Also verify that the system has been properly assembled and that each component inserted in any fall arrest system, in order to regulate the other components correctly and not compromise the efficiency of the system you must take into account the length of the connector.

Using a personal protection device against falls does in no way justify exposing yourself to any type, even fatal, risk.

The user is responsible for the risks to which he exposes himself. The manufacturer and the sellers decline any and all responsibility in case of incorrect use, improper application or for products having been modified or repaired by persons not specifically authorized by producer. The producer assumes the responsibility only for the use for which the product is designed and is not responsible for cases of bad maintenance and for cases of user negligence which can aggravate the dangerous conditions which can arise during the use of the connector. The producer declines any and all responsibility for accidents, injuries or death due to improper and incorrect use of its products by the user. The producer declines any and all responsibility for all the cases in which the above-mentioned instructions are not followed.

The producer declines any and all responsibility for cases in which a finished product is put on the market without the instructions and technical card. It's essential for the safety of the user that if the product is re-sold outside the original country of destination the reseller shall provide these general instructions for use in the language of the country in which the product is to be sold.

IMPORTANT: Before using the connector always check its condition; there must not be any signs of wear, corrosion, deformation or defects in general. If you have any doubts, do not use the connector and replace it immediately. The closing system must function perfectly and to help assure this, the connector must be adequately lubricated. These devices have been designed for use in weather conditions normally tolerated by man. While using the connector and other personal protection devices, the user must always remain below the anchor point. The anchor point must have a minimum resistance of 12KN. The position and the height of the anchor point from the ground must be calculated in view of a possible fall, taking into account the length of the rope and of the devices connected to the rope, any dangerous obstacles, and the possibility of a “swinging” effect. The work must be carried out in such way as to minimized both the potential for fall and potential fall distance.

Verify that a technical identification and control card in conformity with standard EN365:2004 is provided with the tool. This card must be filled in and kept updated by the user. If the card is missing, do not use the device.

The product should only be used in instructed and no alterations should be made to it. It may be used in conjunction with any appropriate items of suitable specification and according to EN standards, with due consideration to the limitations of each individual piece of equipment.

The product shall not be used outside its limitations, or for any purpose other than that for which it is intended. Note however that any dangers that may arise be the use of combinations of items of equipment in which the safe function of any one item is affected by or interferes with the safe function or another.

MATERIAL – All the material and treatments used are antiallergenic; they do not cause skin irritations or sensitivity. The connector was made by Aluminum alloy 7075

MARKING – The following information is etched on the connector:

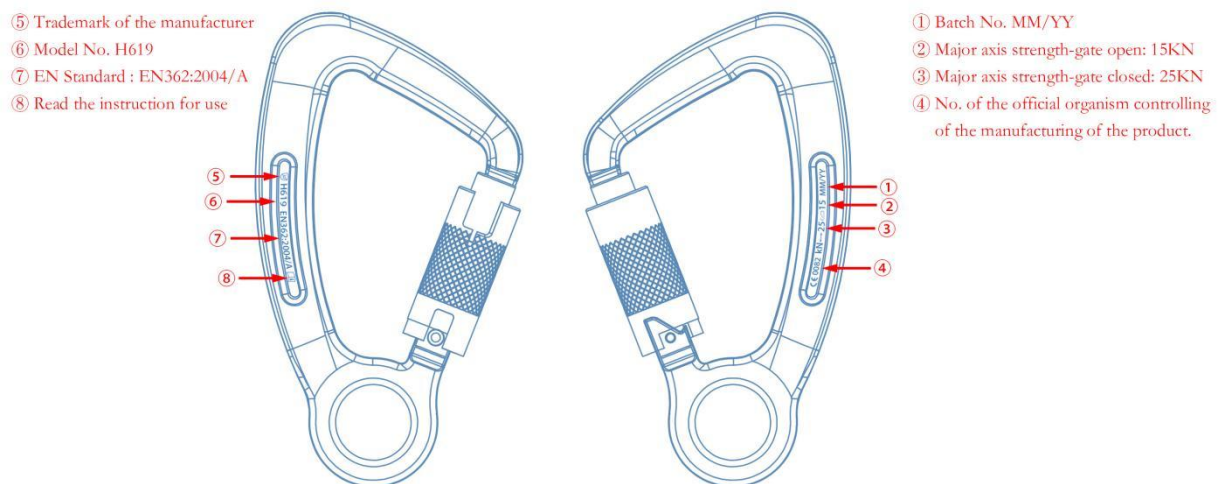

- ① Batch No.MM/YY
- ② Major axis strength-gate open: 15kN
- ③ Major axis strength-gate closed: 25kN
- ④ No. of the official organism controlling of the manufacturing of the product.
- ⑤ Trademark of the manufacturer
- ⑥ Model No. H619
- ⑦ EN Standard: EN362:2004/A
- ⑧ Read the instruction for use

And The size of these products is marked on a label attached at package and they are available in the following sizes:

- 1) Commodity: Aluminum Carabiner;
- 2) Model No.: H619
- 3) Gate Opening : 25mm
- 4) Unit Weight : 110g
- 5) Min. tensile strength : 25kN

INSTRUCTION FOR USE

This equipment is intended for use as a connector in personal fall arrest systems, work positioning, travel restraint and rescue system. The use of this equipment, combining with other components of personal protective equipment, must conform to these instructions of use and to the standards which apply. The length of the connector should be taken into account when used in any fall arrest system as it will influence the length of fall. The anchor point of the system should preferably be located above the position of the user and must have a strength, in particular the minimum strength = 12kN

A fall arrest harness is the only device allowable for supporting the body in a fall arrest system. It is essential to check the required clearance below the user before each use, in order to avoid any impact with the ground or with obstacles in case of a fall.

Warning: Certain situation may reduce the strength of the connector, e.g. connecting wide straps.

Connection

The user of the connectors with self-closing and manual-locking does not have to attach and remove the connector frequently. For correct use and for connection to a safe anchor point, to a subsystem (for example, energy absorber, a lanyard and a connector) and other components of a fall arrest system. The anchor point of the system should preferably be located above the position of the user and must have a strength according to EN795:2012 (>12kN) (picture④).

The anchor connector should be correctly connected to the anchorage which is reliable and includes anchor devices, anchor points or horizontal lifelines, etc (picture①②) . When using with horizontal lifelines and harnesses, the end of the lanyard with the anchor connector should be attached to the horizontal lifeline and the other end of lanyard should be attached to the D-ring or carabiner on the back of the harness (picture③).

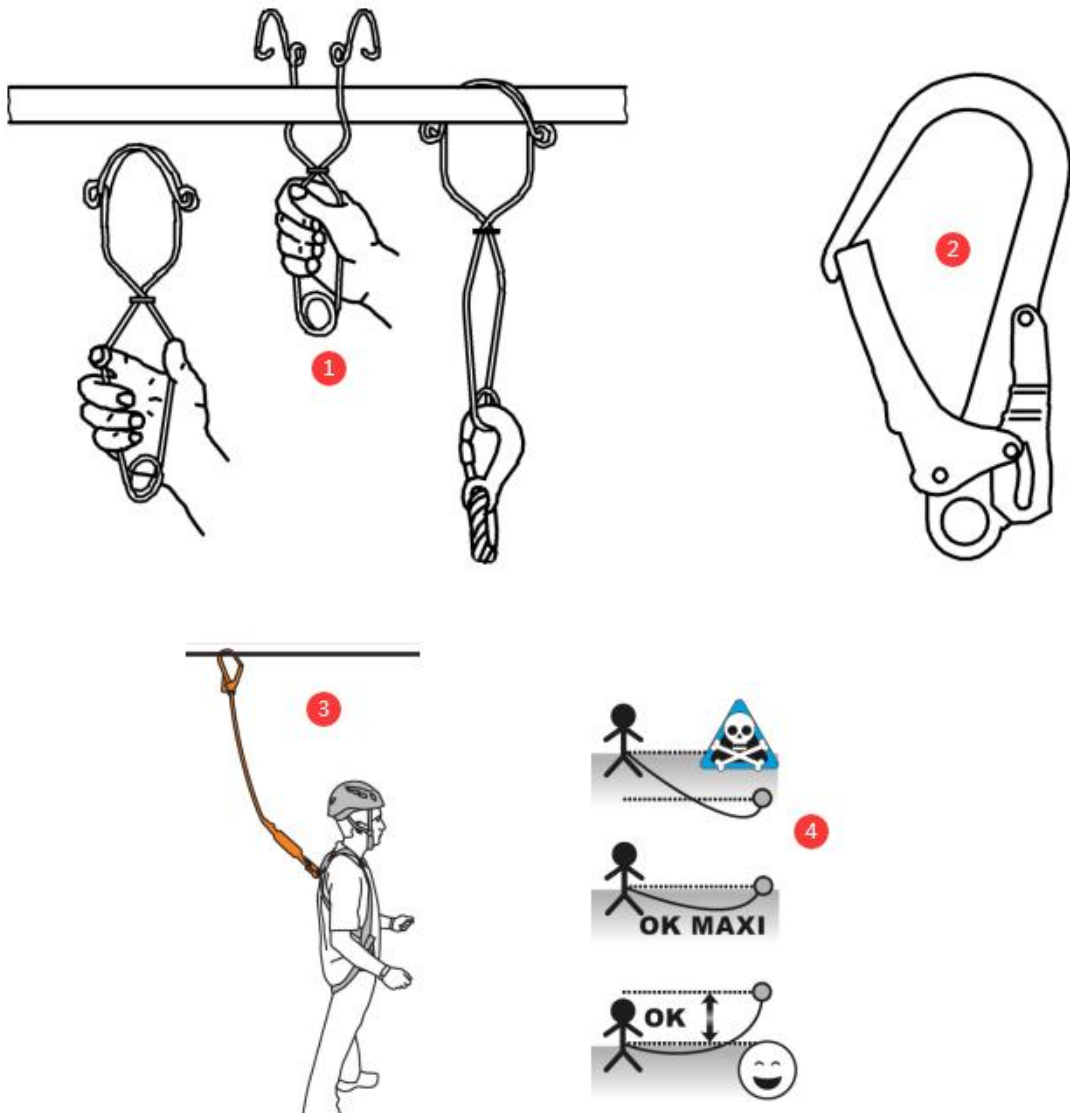

MAINTENANCE – ALWAYS CHECK before and during use that connector works properly.

ALWAYS REPLACE the connector after a fall even if no defect or damage is visible; the initial resistance of the connector could be seriously reduced. The possibility of re-using the device must be authorized exclusively by the producer with a prior written consent who reserves the right to carry out appropriate examinations and testing. Any repair shall only be carried out in accordance with producer's procedures.

REPLACE the connector that shows signs of wear and corrosion.

REPLACE the connector if opening and /or closing/locking are difficult.

Warning: the cleaning procedure must be strictly adhered to.

Clean the connector with soft water and dry naturally and keep away from heat temperature.

Temperature : Always keep this product below 80°C so as not to affect the performance of the product. Chemicals, withdraw the product from service if it comes into contact with chemical reagents, solvents, or fuels which could affect the performance of the product.

LUBRICATE the mobile components with a specific silicone based lubricant. If the connector comes in contact with salt water, wash it immediately and lubricate it. All necessary maintenance operations must be carried out by competent persons explicitly authorized and scrupulously following the operational instructions established by the producer.

DISINFECTION—Dissolve a disinfectant which contains quaternary ammonium salts in warm water(max.20°C). Soak the tool in this solution for one hour. Rinse with potable water and dry with a clean cloth.

STORAGE AND TRANSPORT—Remove the item from its container and store it in a cool, dry, well-aired place. There must not be any

corrosive or solvent substances or heat sources(max.100°C) in the storage place.

The connector must not come in contact with other sharp articles which could damage it. Never store the equipment before having thoroughly dried it and avoid storing it in places with a high saline concentration. Except for the above-mentioned indications, there are no special precautions to be used during the transport. Avoid leaving your equipment in a car or in a closed place exposed to the sun.

LONGEVITY—It is very difficult to establish the longevity of the product, as this can be influenced by various factors such as : -- frequent or improper use; the environment: humidity; freezing and ice; wear; corrosion; serious stress with relative deformation; exposure to heat sources; improper storage; age.

The proper storage of the new connector can guarantee limitless longevity. The average longevity of a connector depends on how is used, maintained and controlled. It can be up to 3 years.

Periodic Examination should be made at least every 12 months and the results are recorded with the connector. The periodic examination is very important . The safety of users depends upon the continued efficiency and durability of the equipment. The periodic examinations are only to be conducted by a competent person as the following instruction. Strictly in accordance with the manufacturer's periodic examination procedures, please see below: a b c . But due to the complexity or innovation of the equipment, where deemed necessary by the manufacture, or where safety critical knowledge is needed in the dismantling, reassembly, or assessment of the equipment, an instruction specifying that periodic examinations shall only be conducted by the manufacturer or by a person or organization authorized by the manufacturer :

- a. If the gate does not come back properly when closing. During the inspection, the gate should be released slowly in order to nullify the spring action.
- b. Wrong or incomplete functioning of the gate closing system. The automatic closing must be carried out completely, without any external aid. In certain environments, contaminants(muds, sand, paint, ice, dirty water etc.) can prevent the automatic locking system from working.

If one of the defects appears, after cleaning, oil the gate mechanism with a silicon based lubricant. Note: cleaning and lubrication is recommended after every use in marine environment. If, after the oiling, the defect persists, the connector has to be put out of use.

- c. Check the legibility of the product's markings. In case of one of the following defects are present, the product should be withdraw from service immediately:
- Deep corrosion(which does not disappear a light rubbing with glass paper)
 - Play or exit of the rivet from the gate
 - Incorrect placement of the gate on the connector body
 - General wear and tear of the body which causes a significant reduction of the body section; presence of dents on body; if the dent depth and/or if the reduction of the body section is greater than 1mm
 - Presence of cracks particularly on the gate axis
- Any product or component showing any defect or ear ,or if in doubt, should be withdraw from service immediately. Each product in the safety system can be damaged during a fall and must be always inspected before use it again. Do not continue to use a product after a major fall because a damage may have occurred, even no external signs are visible.

The below is periodic examination record sheet, please write down the results after every periodic examination and keep the records for checking.

Commodity & Model No. & Type of the PPE:	
Serial No. :	Trade Name:
Production Batch No./Year of manufacture:	
Purchase date:	Date of first use:
User :	
Company name:	
Address:	
Tel:	Contact person:
Manufacture: SEA SUN PROTECTIVE EQUIPMENT CO.,LTD. 39 Xiaokang Rd.,Dongchen,Rugao 226500,Jiangsu,China TEL: +86(0)513 87618751	
Inspection every 12 months	

Date	Results	Name/signature	Date next control

You can download the User Instruction from our website:
www.seasunsafe.com